

Disney FROZEN

PRINCESS CAPE



Make Your Very Own Princess Capes

Adult supervision is required for this craft.



Elsa's Magical Translucent Style Cape

You will need:

- Blue shimmery fabric (2 yards)
- White shimmery fabric (2 yards)
- White Yarn (1 yard)
- White thread
- Sewing needle

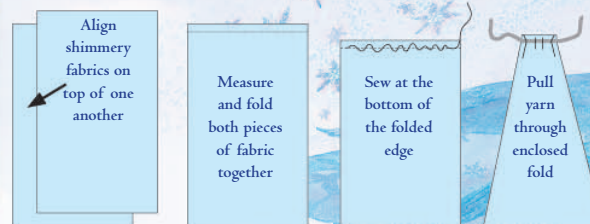

Directions:

1) Cut 2 yards of blue shimmery fabric. 2) Cut 2 yards of white shimmery fabric and align them on top of one another. 3) Measure 4 inches from the top and fold.

4) Sew at the bottom of the folded edge to create an enclosed fold. 5) Pull white yarn through the enclosed fold leaving six inches on each side to tie.



Anna's Wool Style Shawl Cape

You will need:

- Raspberry wool fabric (2 yards)
- Black ribbon (4 yards)
- Hooking style clasp
- Raspberry thread
- Sewing needle
- Hot glue gun

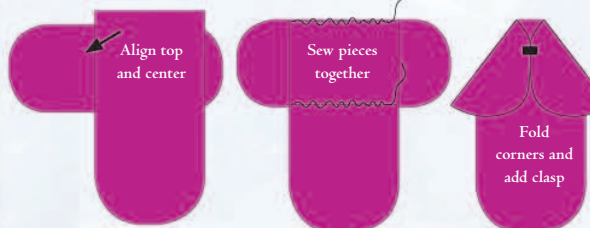

Directions:

1) Cut 1 yard of raspberry wool fabric and cut the corners on both sides to round them off. 2) Cut a second piece of raspberry wool fabric and cut the corners on one end to round them off (keep the opposite ends corners square). 3) Align at the top and center as indicated above.

4) Sew the two pieces of fabric together as indicated above. 5) Add black ribbon around the outer edge with a hot glue gun! 6) Fold the rounded corners of the shawl cape down and sew a hooking style clasp towards the top.



ON DIGITAL HD NOW AND
BLU-RAY™ COMBO PACK MAR 18

